



ARMA AUTOMOTIVE INC. Kit Car Sales Offer

Arma is offering enthusiasts the exclusive opportunity to reserve our first production kit with a deposit.

Engineered for performance, striking aesthetics and daily usability, our first lightweight mid-engine performance car kit will be available upon completion of development.

This is a complete chassis and body package, designed for builders to install their own drivetrain, suspension and interior - perfect for custom builds and personal vision.

Secure your limited early production slot today.



The Ultimate Hands-On Performance Car

A striking, lightweight mid-engine platform built for enthusiasts who crave a pure, high-performance driving experience.

Engineered for speed and agility, with a rigid modular chassis and optimized aerodynamics for serious driving.

The chassis is a lightweight, high-strength mild steel tube frame with removable sections for easy maintenance and repair.

Lightweight carbon fiber body panels are included and come unpainted, ready for finishing. For durability, the panels must be painted, as they do not include UV protection in their raw form.

These panels are designed for strength, lightness, and ease of installation — not for a visible weave finish. For a clean and professional result, we recommend a painted exterior.

Choose your own engine, suspension, and interior to match your vision — or follow our reference parts list and installation guides for a proven setup.

Designed for spirited driving, whether on the road or on the track.

Engineered for builders, with a well designed modular chassis and bodywork that minimizes fabrication time.



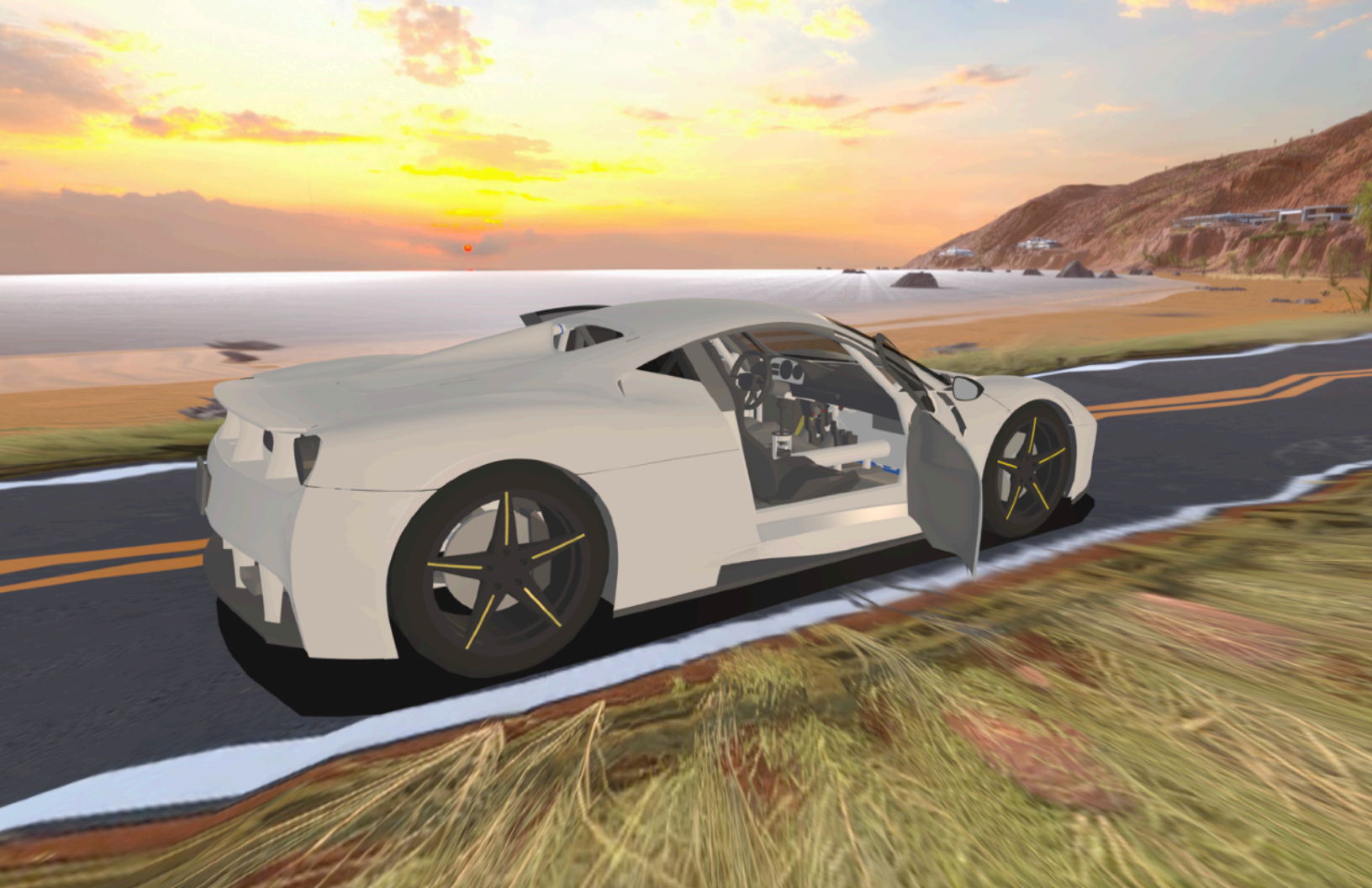





What You'll Need to Build Your Arma Kit Car

Building a high-performance car is a hands-on journey — and part of the reward is assembling it yourself. To complete your Arma kit, here's what you'll need:

- **Basic Tools & Equipment** – A standard set of hand tools, power tools, and floor jacks or lifts will cover most of the assembly. Some light fabrication may be required, especially if you're using non-reference components or making modifications.
- **A Suitable Workspace** – A garage or workshop with enough room to work comfortably is essential. You'll need space not only for the chassis and body but for all the additional components during the build process.
- **Mechanical Skills (or a Willingness to Learn)** – You don't need to be a professional mechanic, but basic mechanical knowledge is important. If needed, enlist help — especially for safety-critical systems like brake lines and steering linkages, which should be installed by a qualified mechanic.
- **Additional Components** – The kit includes the full chassis and bodywork. You'll supply your own engine, transmission, suspension, and interior. We provide a reference parts list to simplify sourcing, especially for first-time builders.
- **Time & Patience** – Like any kit car, building takes time — but the result is a bespoke supercar that reflects your vision. Experienced builders can complete the project in around 300 hours, but the industry average build time ranges from 2 to 3 years, depending on commitment and complexity.
- **Budget for Additional Parts** – We provide the structural core; your final cost depends on your component choices. Some builders invest in premium performance parts, while others keep costs down with used or refurbished gear. To help you gauge the total project scope: Our first vehicle was completed with approximately \$40,000 in components, plus \$25,000 in professional mechanic and paint services.

Regulations & Inspections: What You'll Need to Know

Kit car registration requirements vary by region. Some areas have specific rules regarding inspections, emissions, safety equipment, and custom vehicle registration. Before purchasing, we strongly recommend contacting your local vehicle registration authority to understand what's required for titling, inspection, and legal road use in your area.

If you're unsure about the process where you live, reach out to us — we're happy to help guide you in the right direction.

What Inspections Typically Involve

While each jurisdiction is different, inspections usually focus on core safety elements, including:

- Functional headlights, brake lights, turn signals, and hazard indicators
- Seat belts and occupant restraints
- Operational brakes and steering
- Properly secured components (with no leaks or visible damage)

Our Experience

Our first vehicle was successfully registered in British Columbia, Canada, after completing a safety inspection at a certified service station. This followed communication with the provincial insurance agency (ICBC) and the Commercial Vehicle Safety and Enforcement agency (CVSE).

Regional Differences

Some regions have straightforward compliance paths — for example:

- B.C. and Alberta (Canada)
- Most U.S. states

Others may have more complex or restrictive requirements:

- Ontario (Canada) requires additional systems such as stability and traction control
- The UAE currently does not permit kit cars or makes registration prohibitively difficult

What to Expect

The process can feel daunting — especially when it involves coordination between multiple agencies. However, in regions where kit cars are allowed, clear guidance is usually available, and local authorities are often helpful in providing the steps you need to follow.

Technical Specifications

Length	4587.5 mm	180.6"
Width (Rear Fender)	2006.6 mm	79"
Width (Front Fender)	1981.2 mm	78"
Width Side Mirrors (Est.)	2209.8 mm (Est.)	87" (Est.)
Height	1180 mm	46.45"
Ground Clearance	114.3 mm	4.5"
Wheelbase	2648.58 mm	104.27"
Max Front Approach Angle	8 Degrees	
Weight Completed (Est.)	1360 Kg (Est.)	3000 Lbs (Est.)
Weight Kit (Est.)	385 Kg (Est.)	850 Lbs (Est.)

Front Wheels	20X9 (ET for C8 Corvette) 5x120 34mm
Rear Wheels	21X12 (ET for C8 Corvette) 5x120 52mm
Front Tires	265/35 ZR 20
Rear Tires	345/30 ZR 21
Camber Range	TBD
Suspension Travel	TBD
Anti Squat	TBD
Anti Dive	TBD
Bump Steer	TBD

Occupant Height (Est.)	1829 mm	72" / 6'
Seat to Roof (Est. with 3" / 76 mm floor to seat cushion)	902 mm	35.5"
Seat base to pedal box (Est. with 6" / 152 mm space seat to rear firewall.)	1130 mm	44.5"
Head to side window	TBD	TBD
Elbow room	TBD	TBD

Engine Bay Length. Measured from half shaft to closest area of firewall. Includes portion of transaxle and engine adapter.	1105 mm	43.5"
Engine Length Estimate. Minimum available engine length with typical transaxle and adapter included. Typical is: 9.25" 235 mm.	870 mm	34.25"
Engine Bay Width	711 mm	28"
Engine Bay Height (Note: Limited by shaft coupling to transaxle.) Chassis can be modified to allow lowering an additional 1.75". Custom rear engine hatch body panel can be made to accommodate taller engines.	736 mm	29"
Transaxle length max (7.25" Length to half shaft axle.)	775 mm	30.5"
Transaxle length back side to axle.	590 mm	23.25"

Specifications are subject to refinement as we complete development and testing. Final dimensions and performance figures may vary slightly.

Engine Compatibility

Chevrolet LS3 V8 6.2L	Fits
Chevrolet LS7 V8 6.2L	Fits
Chevrolet LT1 V8 6.2L	Fits
Chevrolet LT5 V8 6.2L	Fits
Ferrari / Maserati F136 V8	Fits
Ferrari F140 V12	Length, width and height limited. Firewall modifications with transaxle shift, fuel cell modifications and engine cover panel modifications.
Ferrari F101 V12	Possible height limit. Engine cover modification.
Lamborghini Gallardo 5.2 V10	Width limited. Fuel cell modification.
Dodge Viper 8.4. V10	Should fit
BMW S85 5.0 V10	Should fit
Toyota 2JZ-GTE Inline 6	Height limited. Engine cover modification.
Toyota 1GZ-FE 5.0 V12	Should fit
Mercedes M120 v12	Width limited. Fuel cell modification.
Ford 5.2 Voodoo	Height limited. Engine cover modification.
Ford 7.3 Godzilla	Height limited. Engine cover modification.
Chrysler HEMI V8	Height limited. Engine cover modification.
Honda K20 / J24	Should fit
Tesla Model S Large Drive Unit	Width limited. Battery cell modification.

Transaxle Compatibility

Porsche G87 Manual 6 Speed	Boxster S / Cayman 2005-2012	Fits
Porsche G50	911	May fit. Modifications needed to invert.
Porsche G96	Carrera 1999-2005	Unknown. Modifications needed to invert.
Porsche 930	911 Turbo 1975-1988	Unknown. Modifications needed to invert.
Audi 01E	S4, S6, A6, A8 1997-2004	Should fit.
Graziano 6-Speed	Audi R8 / Lamborghini Gallardo	Should fit.
Mendeola S4 / S5	Sand cars / Desert / Buggy	Should fit.
Albins ST6-M	Racing	Unknown

Each combination of engine and transmission will require special chassis mounts. This requires metal fabrication work.

Essential Components Needed (Not included in Kit)

The Arma Kit has been designed to use the Chevrolet Corvette C8 vehicle suspension elements including control arms and knuckle hub along with the front coil-overs. These components are designed for this kit so that the specified wheel and tyre sizes fit within the fenders at ride height and give the vehicle it's desired driving characteristics that affect suspension performance during compression for acceleration squat, brake dive, turn lean, bumps steer and other considerations.

Parts List:

Front Driver Side Lower Control Arm - GM	85561494
Front Driver Side Lower Control Arm - GM	85561494

Front Driver Side Steering Knuckle - GM	86556640
Front Passenger Side Steering Knuckle - GM	86556641
Front Passenger Side Upper Control Arm - GM	84831806
Front Driver Side Upper Control Arm - GM	84831805
Rear Passenger Side Lower Control Arm - GM	85561493
Rear Driver Side Rear Lower Control - GM	85561492
Rear Passenger Side Suspension Knuckle - GM	23428470
Rear Driver Side Suspension Knuckle - GM	23428469
Rear Driver Side Suspension Upper Control Arm - GM	84831807
Rear Passenger Side Suspension Upper Control Arm - GM	84831808
Front Wheel Hub - GM	84992878
Side Windshield Left - Ferrari	81487300
Side Windshield Right - Ferrari	81487500
Driver side door latch - GM	13540957
Passenger side door latch - GM	13540958

Note: Some additional components may be needed that are not listed here.

Additional Components Needed (Not included in Kit)

The following is component categories are needed to complete a vehicle build. Many options are available to suit your preference. A reference list of suggested components is available on request.

Power Train

Engine, transaxle + adapter, mounts, exhaust, half shafts, ECU controller, fuel cells, fuel pump, clutch, brake lines, coolant hoses, radiator, shifter and linkage.

Wheels, Brakes and Suspension

Rims, tires, brake rotors and calipers, suspension coil-overs.

Electrical

12v battery, battery box, wiring harness, front high and low lamps, turn indicators, rear signal / brake lights, controller / fuse box.

Interior

Seats, seat belts, pedals, hand brake lever, steering rack / column / wheel, instrument cluster, console buttons, rear view mirror.

Glass

Side windows, side mirrors. weather stripping.

Body Paint.

The body panels included in the kit require paint for UV protection.

What engineering work is needed.

We are working to make our kits as complete as possible, however we are unable to currently provide the following components.

Windshield wipers

Windshield wipers including motor, mounts, linkages are not included with the kit.

Power Windows

Side window power operation is not included with the kit. Slider rail tracks are included with the door frame but the mechanism and electronics to actuate the window is not included.

Parking Brake

Parking brake, lever, linkage cable and calipers are not included with the kit.

Other

There may be other commonly used components you may want in the vehicle that are not listed here. If there are any questions about the kit please reach out.

Kit Contents

The kit includes the following components to

Chassis

The Arma Zen

Front Bumper

Hinges

Door Latch and Locks.

Key card lock unlock.

Body Panels

The following carbon panels are included in the kit. Note these designs are subject to change. Materials and thickness are projections and may vary based on testing.

Interior:

Interior panels made from carbon for weight reduction and stiff durable daily use.

Headliner Panel:

Material: 4 Layers Carbon, 2x2 weave, 200gsm fabric.

Size: 1650 inch/square, 1.06 meters/square

Weight: 1.431 kg, 3.15 Lbs.

Price: \$630 CAD, \$438 USD (Single part)

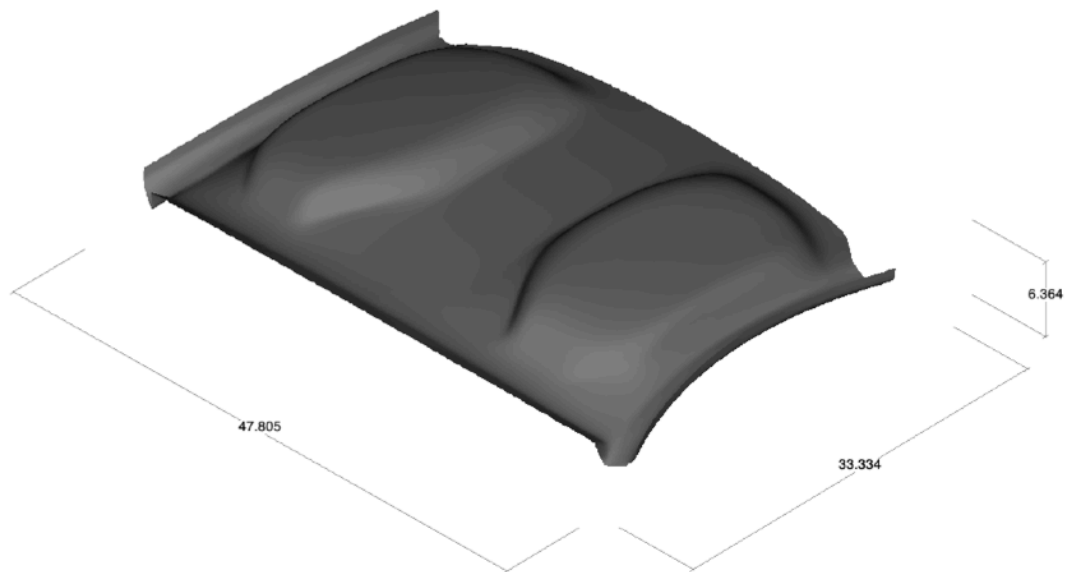

Floor liner panel: (Left + Right Side)

Material: 2 Layers 200 gsm + 3 Layers 450 gsm.

Size: 2120.99 inch/square, 1.368 meters/square

Weight: 6.7 kg, 7.95 Lbs.

Price: \$830 CAD, \$577 USD each.

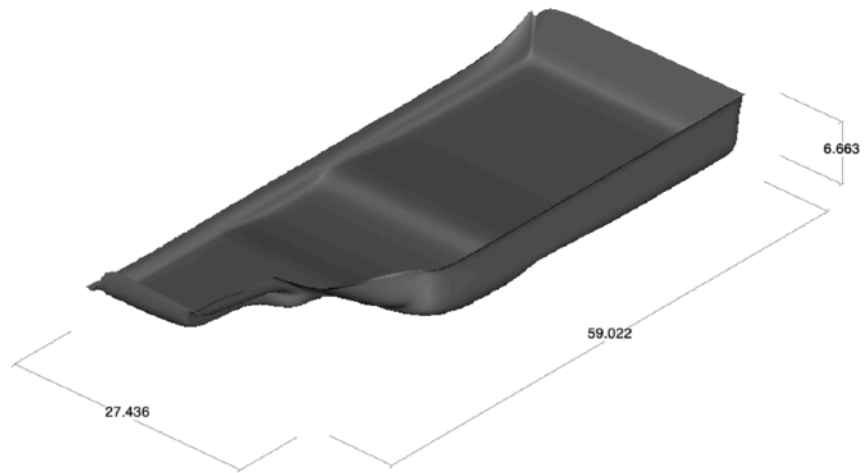

Door Cards (Left + Right Sides)

Material: 8 Layers carbon fibre.

Size: 1538 inches/square, 0.99 meters/square

Weight: 2.7 Kgs., 5.95 Lbs.

Price: \$907 CAD, \$631 USD each.

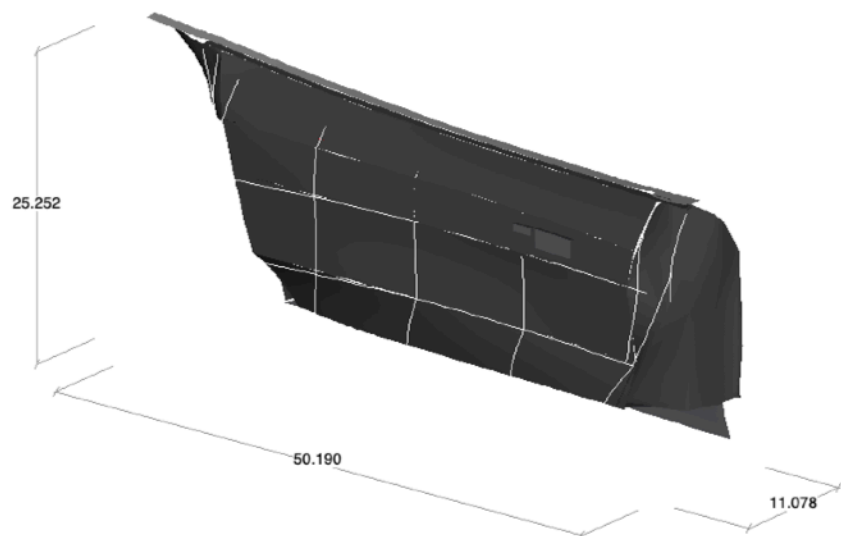

Foot Well (Left + Right Side)

Material: 8 Layers.

Size: 514 inch/square, 0.33 Meters/square

Weight: 0.89Kgs. 1.97 Lbs.

Price: \$550 CAD, \$380 USD each.

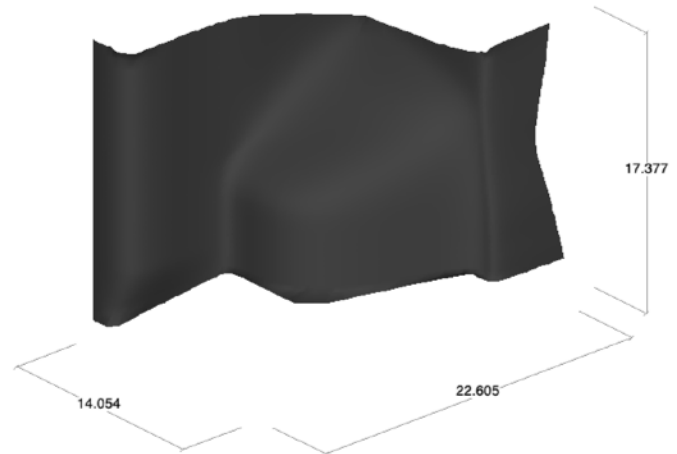

Windshield Mount (1 Piece)

Material: 10 Layers.

Size: 1832 inches/square., 1.181 meters/square.

Weight: 3.18Kg, 8.4Lbs.

Price: \$993 CAD, \$690 USD.

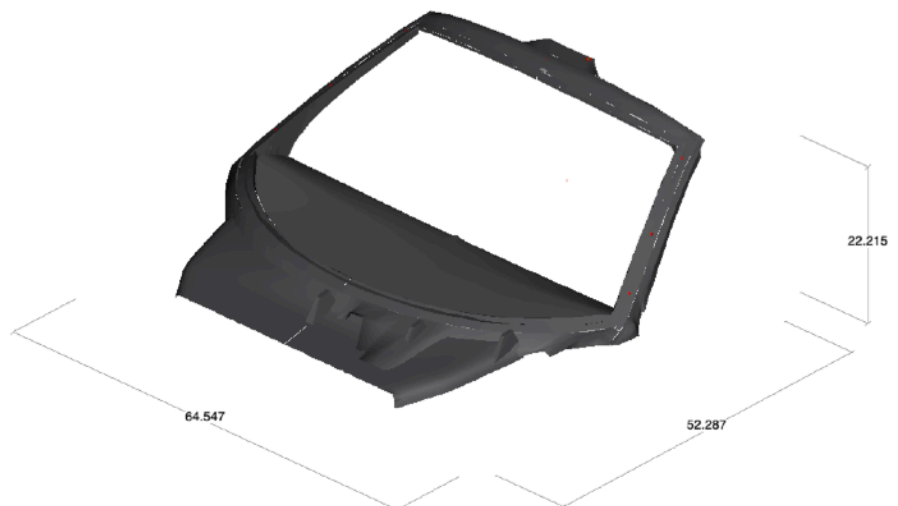

Front Storage Panel (1 part)

Material: 8 Layers.

Size: 2625 inches/square., 1.7 meters/square.

Weight: 4.59Kg, 10.1Lbs.

Price: \$1280 CAD, \$890 USD.

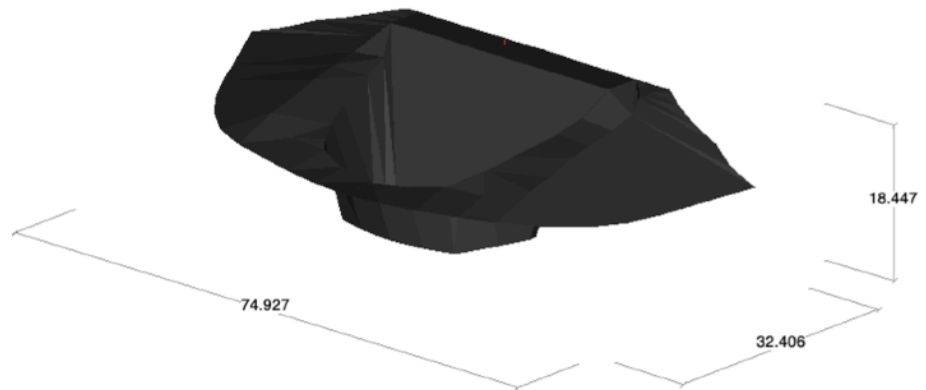

Sun Visors (Left + Right Side)

Material: TBD

Size:

Weight:

Price:

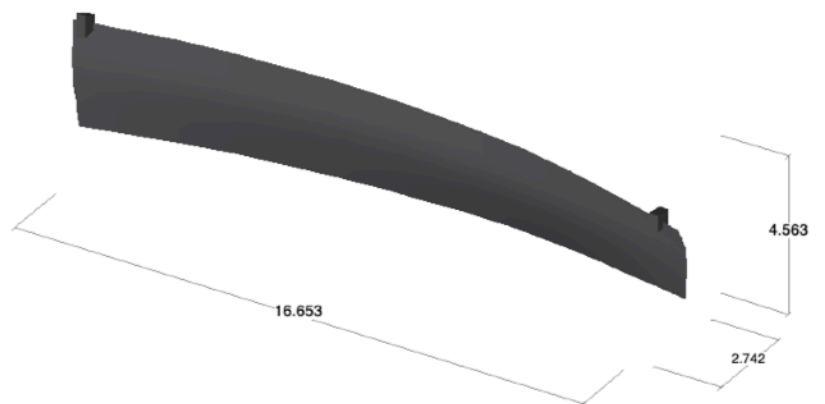

Rear Engine Cover Support (1 Part)

Material: 8 Layers.

Size: 550 inch/square, 0.35 Meters/square

Weight: 0.95Kgs. 2.09 Lbs.

Price: \$550 CAD, \$380 USD.



Rear Firewall (1 Part)

Material: 8 Layers

Size: 1090 inch/square, 0.7 meters/square

Weight: 1.89 Kgs., 4.16Lbs

Price: \$747 CAD, \$519 USD.

* Note: Can be omitted and replaced with an aluminum panel.

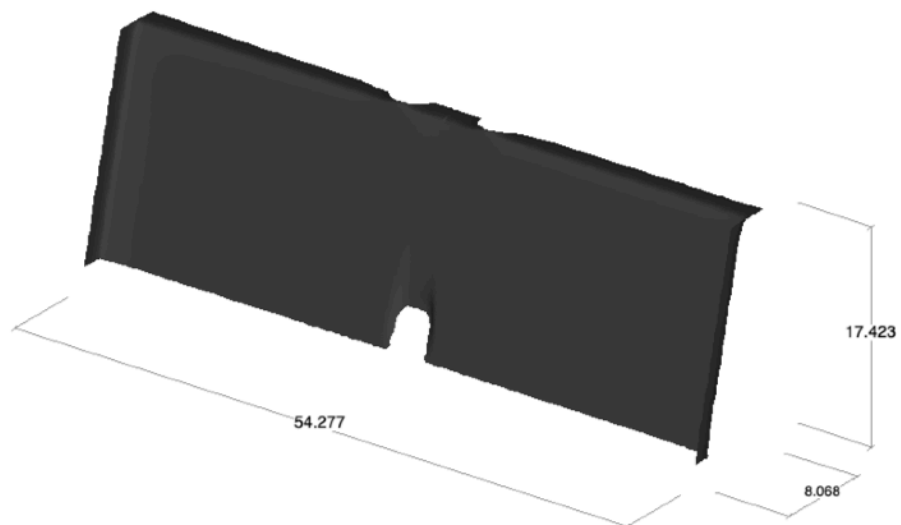

Fender Liners (4 Pieces)

Material: 2 Layers.

Size: 1660 inches/square, 1.07 meters/square

Weight: 0.675 Kgs., 1.5 Lbs.

Price: \$390 CAD, \$270 USD.

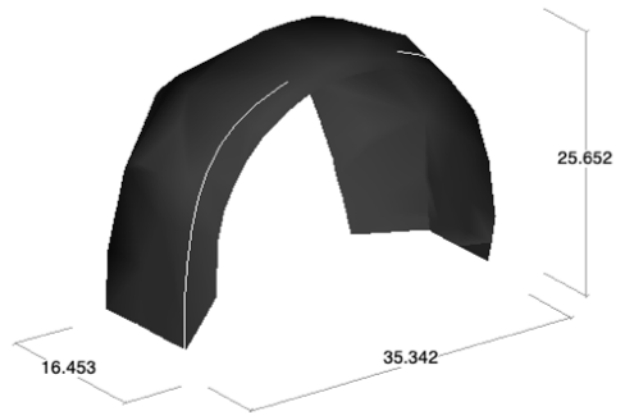

C Pillar Covers (Left + Right Side)

Material:

Size:

Weight:

Price:

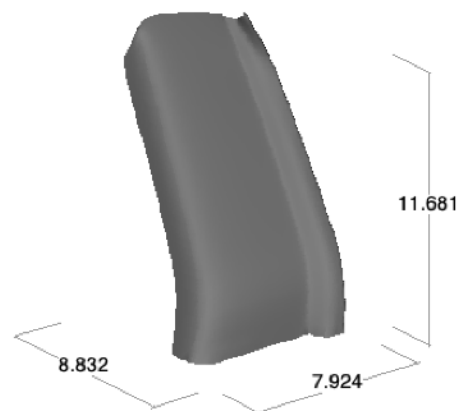

Exterior:

Door (Left + Right Side)

Material: 2 Layers 200 gsm + 3 Layers 450 gsm.

Size: 1273 inch/square., 0.821 meters/square.

Weight: 2.22Kg, 4.85Lbs.

Price: \$812 CAD, \$565 USD.

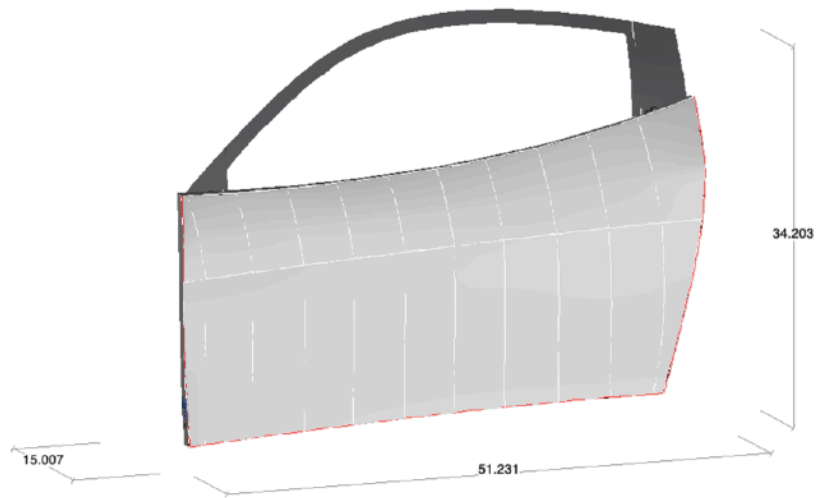

Roof

Material: 2 Layers 200 gsm + 3 Layers 450 gsm.

Size: 2172 inches/square., 1.4 meters/square.

Weight: 3.78 Kg, 8.33 Lbs.

Price: \$1120 CAD, \$780 USD

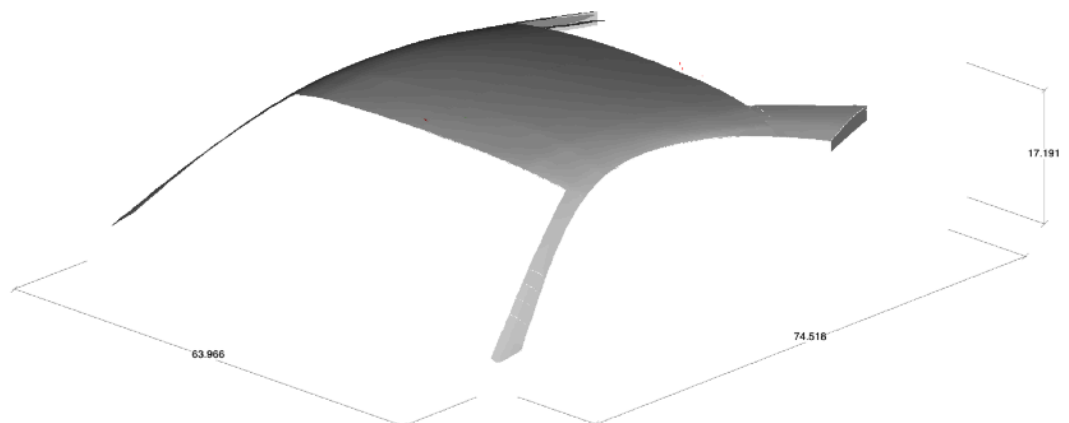

Front Hood

Material: 2 Layers 200 gsm + 3 Layers 450 gsm.

Size: 3494 inch/square., 2.25 meters/square.

Weight: 6.08Kg. 13.4Lbs.

Price: \$1573 CAD, \$1085 USD.

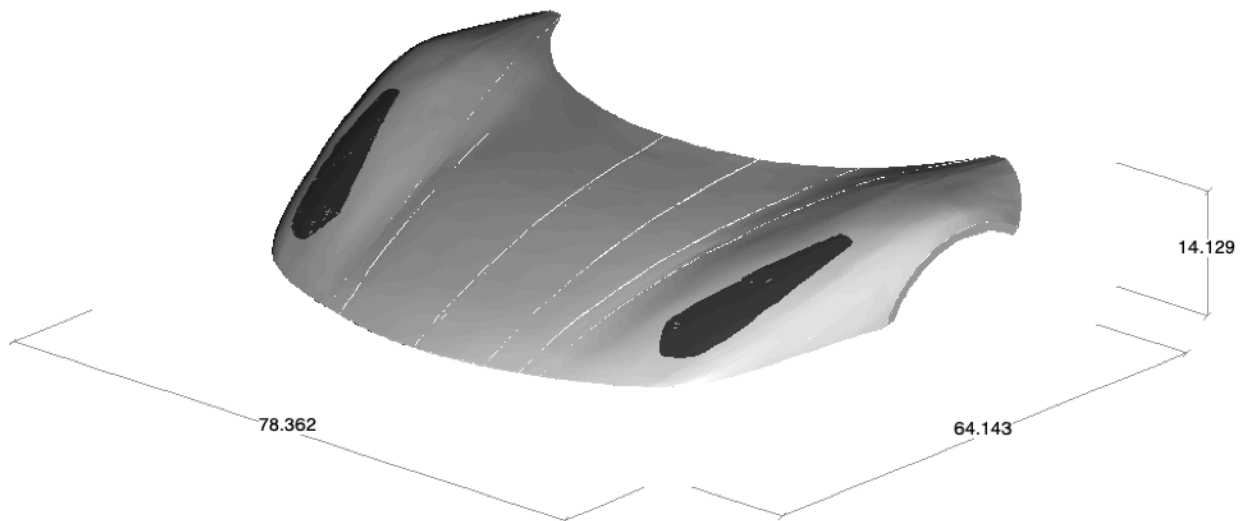

Front Bumper (Single)

Material: 2 Layers 200 gsm + 3 Layers 450 gsm.

Size: 2813 inch/square., 1.814 meters/square.

Weight: 4.9 Kg, 10.8Lbs.

Price: \$1340 CAD, \$932 USD

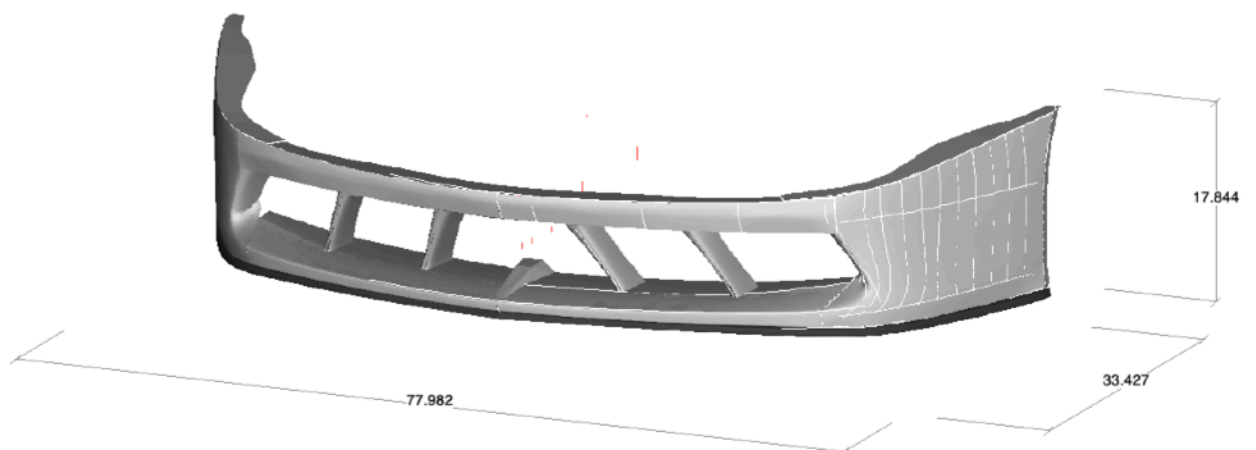

Side Skirt (Left + Right Side)

Material: 8 Layers 200 gsm.

Size: 2900 inch/square., 1.87 meters/square.

Weight: TBD

Price: \$1340 CAD, \$966 USD.

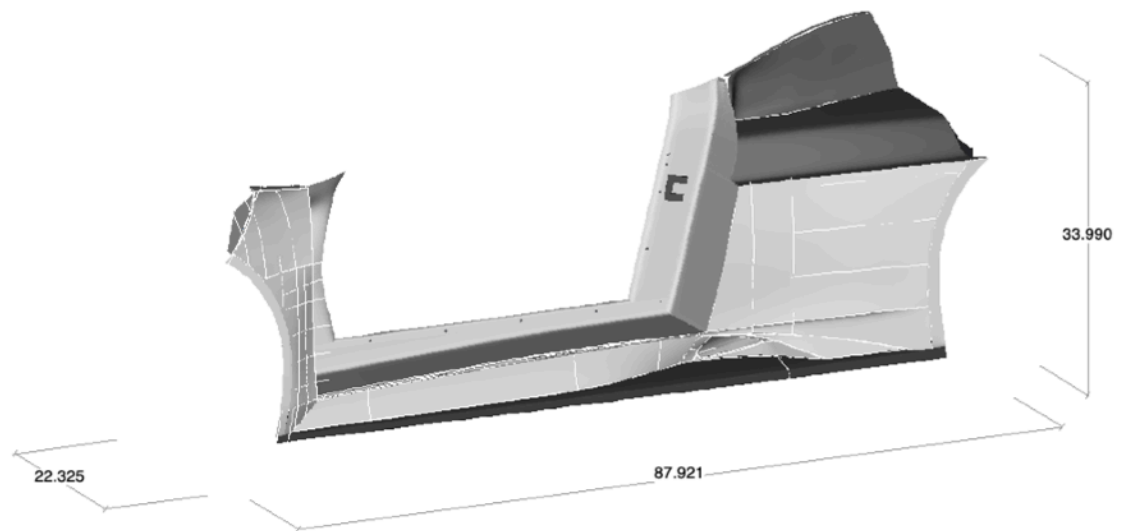

Rear Fender (Left + Right Side)

Material:

Size: 1311 inch/square., 0.85 meters/square.

Weight: TBD

Price: \$827 CAD, \$575 USD each.

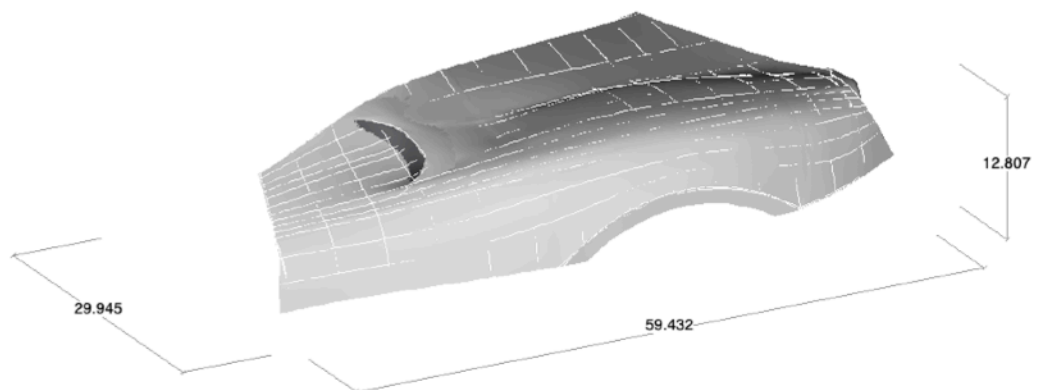

Engine Cover (1 Piece)

Material: 8 Layers.

Size: 1826.626 inches/square, 1.178 meters/square

Weight: 3.18Kg, 8.4Lbs.

Price: \$993 CAD, \$690 USD.

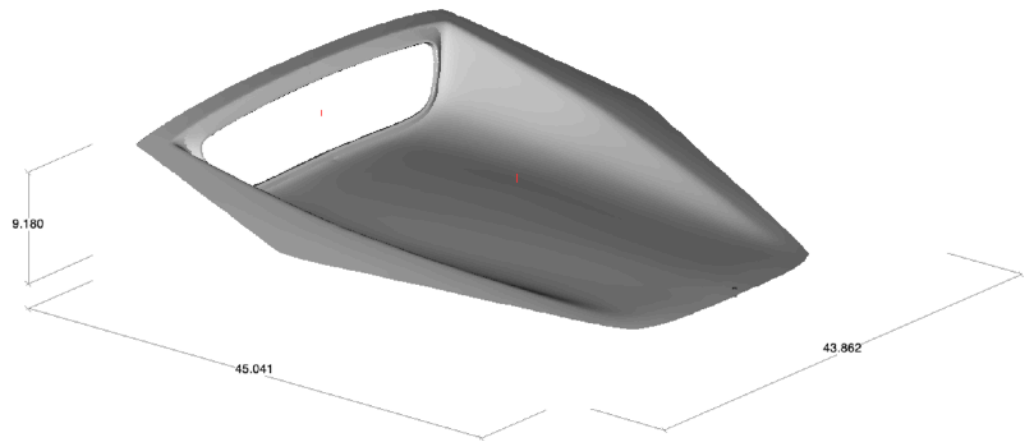

Rear Tail Spoiler (1 Piece)

Material: 8 Layers.

Size: 1380 inches/square, 0.89 Meters/square

Weight: 2.4 Kgs., 5.3 Lbs.

Price: \$827 CAD, \$575 USD.

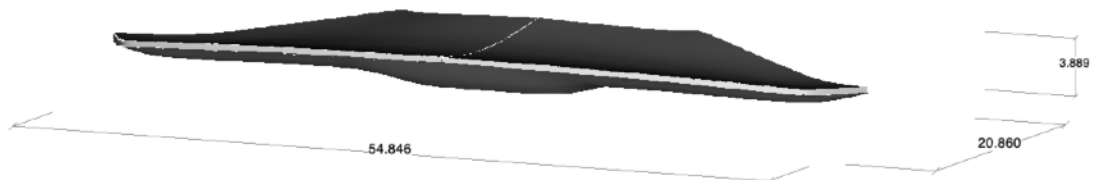

Rear Bumper (1 Piece)

Material: 8 Layers.

Size: 2082 inches/square, 1.343 meters/square

Weight: 6.62 Kg, 14.59 Lbs.

Price: \$1090 CAD, \$758 USD.

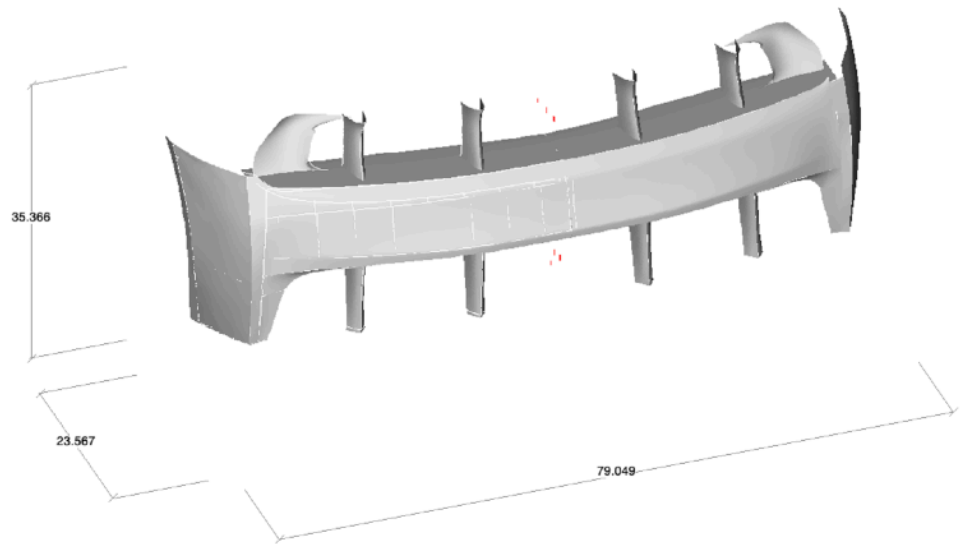

Rear Diffuser

Material: 8 Layers.

Size: 1832 inches/square, 1.181 meters/square

Weight: 3.18Kg, 8.4Lbs.

Price: \$993 CAD, \$690 USD.

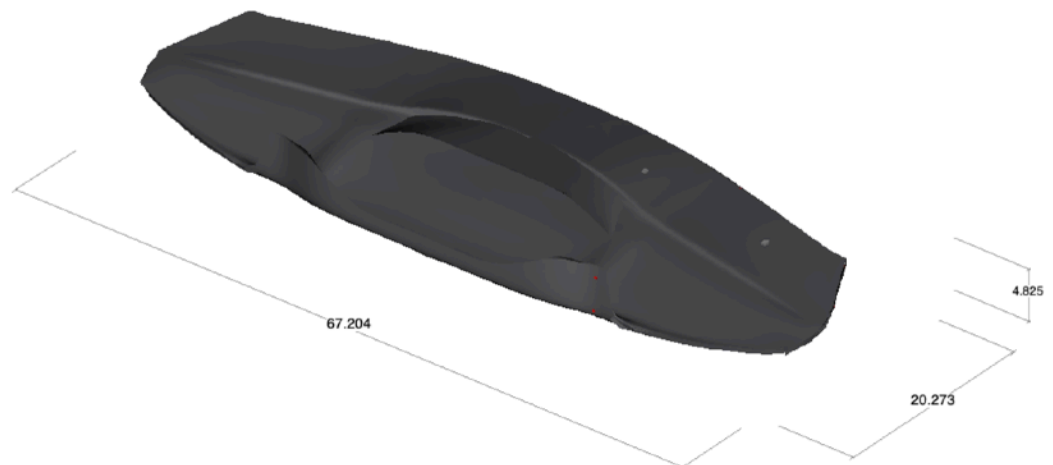

Summary and Total

Body panels interior and exterior are available individually for replacement or as options to remove from a kit purchase.

Total: \$16,747 USD, \$23,928 CAD.

Weight: 66.43Kg, 146.471Lbs

Glass Front Windshield

Front Windshield

Material: DOT Safety Glass.

Weight: TBD

Price: **\$5000 CAD,**

Rear Lexan Firewall

Material:

Size:

Weight:

Price:

Interior

Panels, Sun Visors.

Stickers - Manual shifter pattern. Required for safety inspection.

TODO:

Offer Details

A deposit of \$16,000 USD is required to reserve your build slot.
The remaining balance will be due prior to shipment.

Total price: \$32,000.00 USD. Final payment due before shipping.

Refund policy

Deposits are partially refundable

Deposits are non-refundable after 14 days but may be transferred to a future build slot

Production is underway, and kits will be delivered as soon as manufacturing is finalized.
Buyers will be updated throughout the process.

Estimated delivery timeframe: [X months from order]

Registration and road legality vary by region. Buyers are responsible for ensuring compliance with local laws.

This kit is sold for assembly by the buyer. The seller is not responsible for any modifications, use, or installation errors that may affect performance or safety.

Contact Form

Full Legal Name: _____

Hereafter referred to as: _____

Phone Number: _____ Email address: _____

Mailing address: _____

City: _____ Province: _____

Postal/ Zip Code: _____ Country: _____